

107.2480"

3668

3068

3668

3636

3668

2468

2468

2468

SG61

SG61

SG61

19GS

19GS

19GS

19GS

19GS

19GS

IBX

2466

IBX

IBX

19GS

19GS

30LF

30LF

BBF

BBF

2468

2472

2468

58.6"

19GS

19GS

33.1"

bookcase

bookcase

113.2637

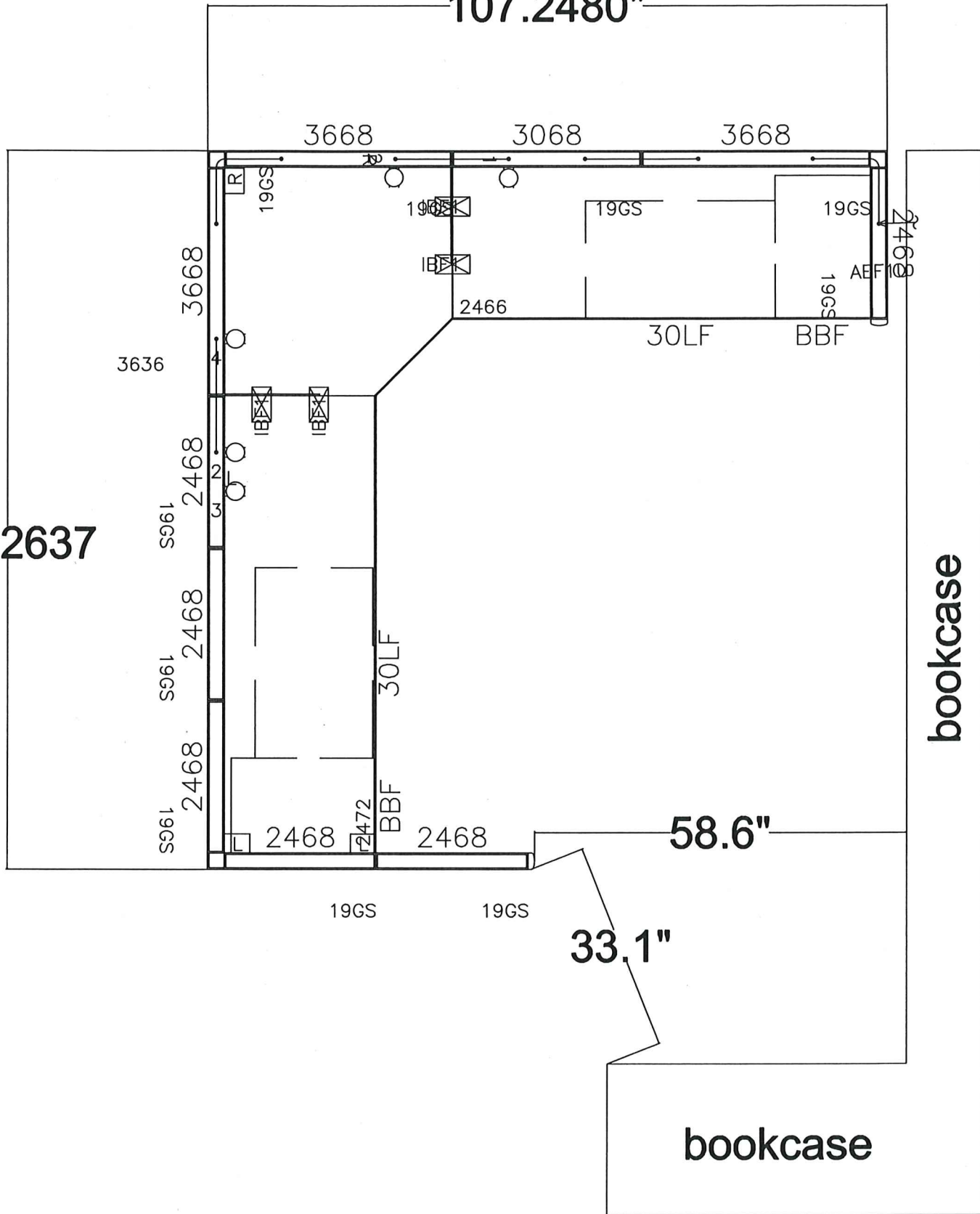

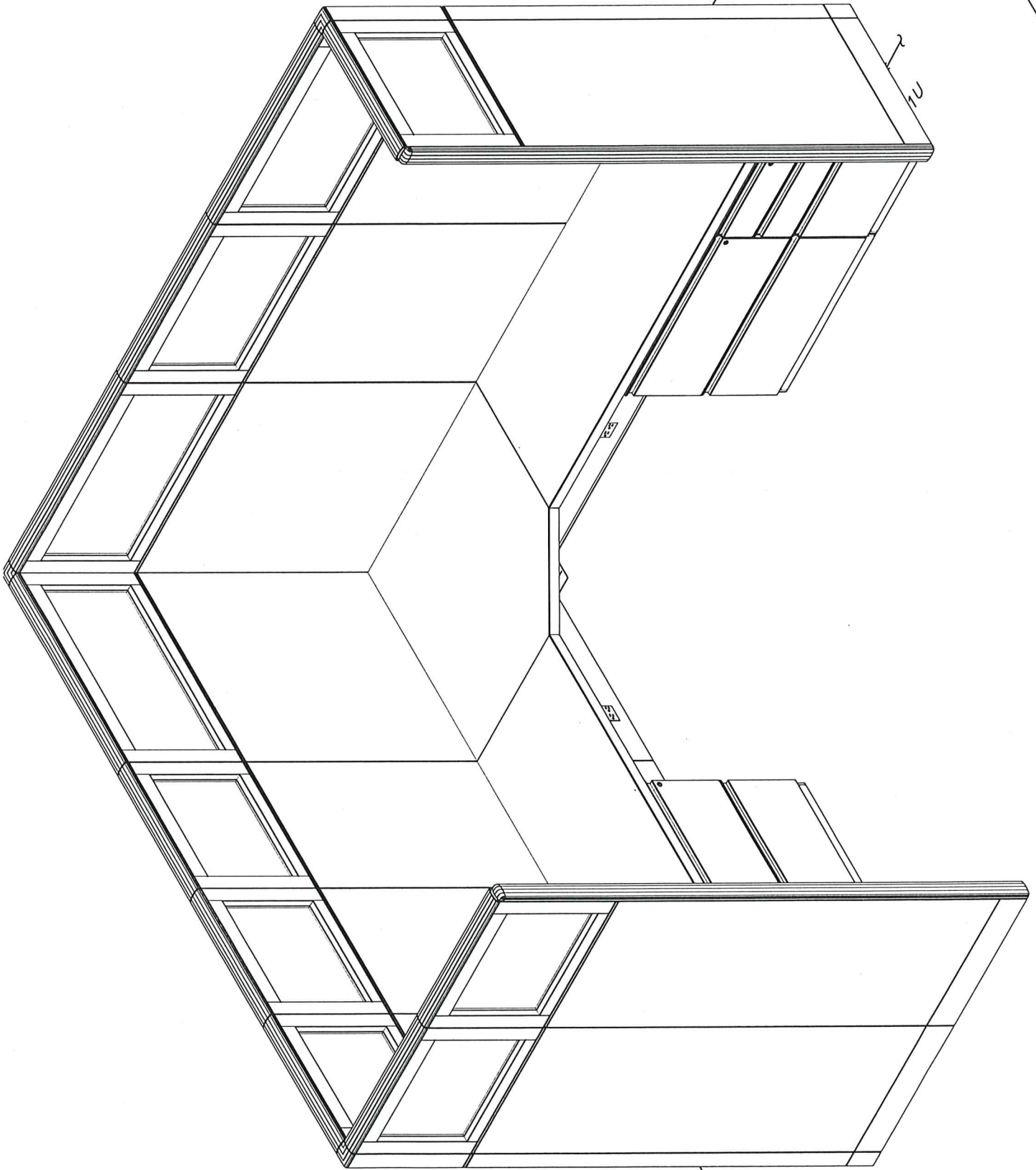

07.12.23

Laurissa Keane
 U.S. District Court - Western District of LA
 800 Lafayette St.
 Lafayette, LA 70501

Item	Mfg	Cat	Part Number	Part Description	Category	Qty
1	KIM	KL3	ACC87P	CETRA,87H,CONNECTOR,END TRIM,STACKABLE,PAINT	Connector	2
			...	Skipped Option		
			...	Skipped Option		
2	KIM	KL3	ACL19P	CETRA,19H,CONNECTOR,SQUARE L,STACKABLE,PAINT	Connector	3
			STD	STANDARD GROUP 1,NON-METALLIC		
			462	CINDER		
3	KIM	KL3	ACL68PP	CETRA,68H,CONNECTOR,SQUARE L,PAINT,PAINT TOP CAP	Connector	3
			C	THIN SQUARE		
			STD	STANDARD GROUP 1,NON-METALLIC		
			462	CINDER		
			STD	STANDARD GROUP 1,NON-METALLIC		
			462	CINDER		
			STD	STANDARD GROUP 1,NON-METALLIC		
			462	CINDER		
4	KIM		KSY01796305153	CETRA 14' BASE POWER FEED - special	Electrical	1
5	KIM	KL3	AEJ1	CETRA,ELECTRICAL,JUMPER CABLE,PANEL-TO-PANEL	Electrical	3
			...	Skipped Option		
6	KIM	KL3	AEJ2	CETRA,ELECTRICAL,JUMPER CABLE,90 DEGREE CORNER	Electrical	2
			...	Skipped Option		
7	KIM	KL3	AER184	CETRA,ELEC,DUPLX RECEPTACLE,8 WIRE-4 CIRCUIT,CIRCUIT 1	Electrical	1
			...	Skipped Option		

07.12.23

Laurissa Keane
 U.S. District Court - Western District of LA
 800 Lafayette St.
 Lafayette, LA 70501

Item	Mfg	Cat	Part Number	Part Description	Category	Qty
8	KIM	KL3	AER284	CETRA, ELEC, DUPLEX RECEPTACLE, 8 WIRE-4 CIRCUIT, CIRCUIT 2	Electrical	2
9	KIM	KL3	AER384	CETRA, ELEC, DUPLEX RECEPTACLE, 8 WIRE-4 CIRCUIT, CIRCUIT 3	Electrical	1
10	KIM	KL3	AER484	CETRA, ELEC, DUPLEX RECEPTACLE, 8 WIRE-4 CIRCUIT, CIRCUIT 4	Electrical	1
11	KIM	KL3	AP3019GSP	CETRA, 30WX19H, PANEL, STACKABLE, GLASS, PAINT FRAME	Panel	1
12	KIM	KL3	AP3068PNPP	CETRA, 30WX68H, PANEL, PAINT, FABRIC, PWRD, PAINT TOP CAP	Panel	1
			84	8 WIRE, 4 CIRCUIT		
			C	THIN SQUARE		
			STD	STANDARD GROUP 1, NON-METALLIC		
			462	CINDER		
			P1	1 PUNCHED, 1 NON-PUNCHED		
			STD	STANDARD GROUP 1, NON-METALLIC		
			462	CINDER		
			STD	STANDARD GROUP 1, NON-METALLIC		
			420	SANDSTONE		
			A	GRADE A		
			15302	UNIVERSE CREME BRULEE		

07.12.23

Laurissa Keane
 U.S. District Court - Western District of LA
 800 Lafayette St.
 Lafayette, LA 70501

Item	Mfg	Cat	Part Number	Part Description	Category	Qty
13	KIM	KL3	AP3619GSP	CETRA,36WX19H,PANEL,STACKABLE,GLASS,PAINT FRAME	Panel	3
			3	CLEAR		
			STD	STANDARD GROUP 1, NON-METALLIC		
			462	CINDER		
14	KIM	KL3	AP3668PNPP	CETRA,36WX68H,PANEL,PAINT,FABRIC,PWRD,PAINT TOP CAP	Panel	3
			84	8 WIRE,4 CIRCUIT		
			C	THIN SQUARE		
			STD	STANDARD GROUP 1, NON-METALLIC		
			462	CINDER		
			P1	1 PUNCHED,1 NON-PUNCHED		
			STD	STANDARD GROUP 1, NON-METALLIC		
			462	CINDER		
			STD	STANDARD GROUP 1, NON-METALLIC		
			420	SANDSTONE		
			A	GRADE A		
			15302	UNIVERSE CREME BRULEE		
15	KIM	KL3	AP2419GSP	CETRA,24WX19H,PANEL,STACKABLE,GLASS,PAINT FRAME	Panel	6
			3	CLEAR		
			STD	STANDARD GROUP 1, NON-METALLIC		
			462	CINDER		

07.12.23

Laurissa Keane
U.S. District Court - Western District of LA
800 Lafayette St.
Lafayette, LA 70501

Item	Mfg	Cat	Part Number	Part Description	Category	Qty
16	KIM	KL3	AP2468PNPP	CETRA,24WX68H,PANEL,PAINT, FABRIC,PWRD,PAINT TOP CAP	Panel	2
			84	8 WIRE,4 CIRCUIT		
			C	THIN SQUARE		
			STD	STANDARD GROUP 1, NON-METALLIC		
			462	CINDER		
			P1	1 PUNCHED,1 NON-PUNCHED		
			STD	STANDARD GROUP 1, NON-METALLIC		
			462	CINDER		
			STD	STANDARD GROUP 1, NON-METALLIC		
			420	SANDSTONE		
			A	GRADE A		
			15302	UNIVERSE CREME BRULEE		
17	KIM	KL3	AP2468PNPP	CETRA,24WX68H,PANEL,PAINT, FABRIC, NON PWRD, PAINT TOP CAP	Panel	4
			C	THIN SQUARE		
			STD	STANDARD GROUP 1, NON-METALLIC		
			462	CINDER		
			NP2	2 NON-PUNCHED		
			STD	STANDARD GROUP 1, NON-METALLIC		
			462	CINDER		
			STD	STANDARD GROUP 1, NON-METALLIC		
			420	SANDSTONE		
			A	GRADE A		
			15302	UNIVERSE CREME BRULEE		

07.12.23

Laurissa Keane
 U.S. District Court - Western District of LA
 800 Lafayette St.
 Lafayette, LA 70501

Item	Mfg	Cat	Part Number	Part Description	Category	Qty
18	KIM	KL8	12S1830LFU2M	FOOTPRINT, 18DX30WX27H, STORAGE, LATERAL FILE, UDSF, METAL, FLAT	Pedestal	2
✓			ARC462	ARC, CINDER		
			KSB	SPECIFY CORE SEPARATELY		
			STD	STANDARD GROUP 1, NON-METALLIC		
			443	PAVESTONE		
19	KIM	KL8	12S2415PUBBFM	FOOTPRINT, 24DX15WX27H, STORAGE, BOX/BOX/FILE, UDSF, METAL, FLAT	Pedestal	2
			ARC462	ARC, CINDER		
			KSB	SPECIFY CORE SEPARATELY		
			STD	STANDARD GROUP 1, NON-METALLIC		
			443	PAVESTONE		
20	KIM	KL8	KSCD001	LOCK CORE, BLACK CORE WITH BLACK HINGED KEY, KEY 001	Lock Core	4
✓						
21	KIM	KL8	ABWC14L	FOOTPRINT, CETRA, CANTILEVER BRACKET, LEFT-HAND	Systems	1
✓						
22	KIM	KL8	ABWC14R	FOOTPRINT, CETRA, CANTILEVER BRACKET, RIGHT-HAND	Systems	1
✓						
23	KIM	KL8	ABWL	FOOTPRINT, CETRA, EDGE SUPPORT BRACKET, LEFT-HAND	Systems	2
✓						
24	KIM	KL8	ABWR	FOOTPRINT, CETRA, EDGE SUPPORT BRACKET, RIGHT-HAND	Systems	1
✓						
25	KIM	KL8	IBF1	FOOTPRINT, FLAT BRACKET	Systems	4
✓						

07.12.23

Laurissa Keane
 U.S. District Court - Western District of LA
 800 Lafayette St.
 Lafayette, LA 70501

Item	Mfg	Cat	Part Number	Part Description	Category	Qty
26	KIM	KL8	ST24363624WSSCL1	FOOTPRINT, 36DX36W, 24R, SURFACE, 1 9/16T, STRT CRNR, HPL, SNGL RIM	Worksurface	1
			P	1/8" MOLDED VIN		
			STD	STANDARD GROUP 1		
			BZ	BRAZILWOOD		
			BZ	BRAZILWOOD		
			0000000665	GROMMET, CENTER		
			50	FACTORY INSTALL 99KG50 CENTER		
			...	Skipped Option		
27	KIM	KL8	ST2466WSSL1	FOOTPRINT, 24DX66W, SURFACE, 1 9/16T, STRAIGHT, HPL, SINGLE RIM	Worksurface	1
			P	1/8" MOLDED VIN		
			STD	STANDARD GROUP 1		
			BZ	BRAZILWOOD		
			BZ	BRAZILWOOD		

			0000000659	ADD WIRE MANAGER, LEFT		
			AWML462	ADD LEFT, CINDER		
			0000000658	ADD WIRE MANAGER, RIGHT		
			AWMR462	ADD RIGHT, CINDER		
			...	Skipped Option		
			0000000665	GROMMET, CENTER		
			50	FACTORY INSTALL 99KG50 CENTER		
			...	Skipped Option		
			...	Skipped Option		

07.12.23

Laurissa Keane
 U.S. District Court - Western District of LA
 800 Lafayette St.
 Lafayette, LA 70501

Item	Mfg	Cat	Part Number	Part Description	Category	Qty
28	KIM	KL8	ST2472WSSL1	FOOTPRINT,24DX72W,SURFACE,1 9/16T,STRAIGHT,HPL,SINGLE RIM	Worksurface	1
			P	1/8" MOLDED VIN		
			STD	STANDARD GROUP 1		
			BZ	BRAZILWOOD		
			BZ	BRAZILWOOD		

			0000000659	ADD WIRE MANAGER,LEFT		
			AWML462	ADD LEFT,CINDER		
			...	Skipped Option		
			0000000658	ADD WIRE MANAGER,RIGHT		
			AWMR462	ADD RIGHT,CINDER		
			...	Skipped Option		
			...	Skipped Option		
			...	Skipped Option		
			0000000664	GROMMET,RIGHT		
			50	FACTORY INSTALL 99KG50 RIGHT		
			...	Skipped Option		
			...	Skipped Option		
29	KIM	KL3	ATET	CETRA,HOOK BRACKET,STACKABLE PANEL TOP BRACKET,HI-LO	Connector	5
30	KIM	KL3	ARPJ36A	CETRA,36W,ELECTRICAL,COMMUNICATION WIREWAY COVER	Electrical	1
			STD	STANDARD GROUP 1,NON-METALLIC		
			462	CINDER		
sub				Subtotal		
				Grand Total		